

480 +/- ACRES OF WESTERN SIOUX COUNTY CROP, PASTURE & HAYLAND

FOR SALE AT ABSOLUTE PUBLIC AUCTION

WEDNESDAY, OCTOBER 27, 2021 at 10:00 AM MST

Beeler Community Center - Lemmon, SD

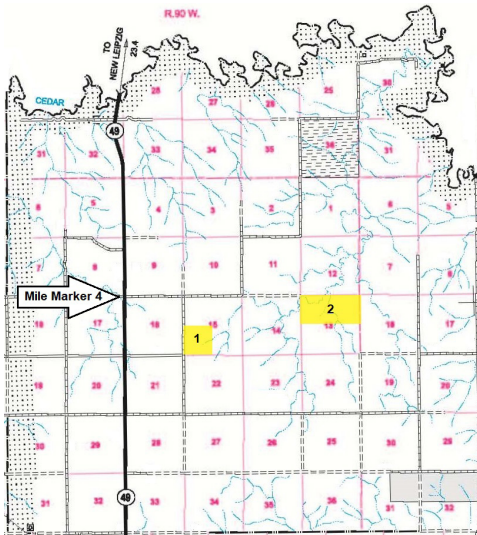

TRACT 1:

Location:

- Four- & one-half miles north of the Junction of ND Highway 49 & US Highway 12 to mile marker 4 then east one mile and one-half mile south.

Legal Description:

- SW ¼ of Section 15, Township 129 North, Range 90 West - Sioux County, ND. (160.0 +/- acres)

Land Use:

- 157.7 +/- acres of highly productive cropland. (PI: 82.7)

TRACT 2:

Location:

- Four- & one-half miles north of the Junction of ND Highway 49 & US Highway 12 to mile marker 4 then east three miles.

Legal Description:

- N ½ of Section 13, Township 129 North, Range 90 West - Sioux County, ND. (320.0 +/- acres)

Land Use:

- 77 +/- acres of hayland
- 243 +/- acres of pasture

FOR MORE INFORMATION PLEASE CONTACT:
Shawn Weishaar – Court Appointed Referee

Home: (701) 376-3582 / Cell: (701) 260-2600

www.weishaarsales.com